

HELMI MACRAMÉ LAMPSHADE

Design: Lankava, Sanna Peltoluhta.

Size: Diameter approx. 20(25)30 cm / 7.75(9.75)11.75", height 60 cm / 23.5".

Cord: Lankava Pamela Macramé Cord (80 % recycled cotton, 20 % polyester, 700 g = approx. 180 m / 197 yds) 205(274)342 m / 225(300)375 yds (= approx. 0.8(1.1)1.4 kg) greige (87)

Other supplies: Lamp shade frame 20(25)30 cm / 7.75(9.75)11.75", metal ring 20(25)30 cm / 7.75(9.75)11.75", removable stitch marker or safety pin.

Square Knot = SK (pic 1): Use 4 cords to make a knot in 2 stages.

Stage 1: Take the left cord over the 2 center cords and behind the right cord, then take the right cord behind the center cords and up and to the front through the loop. Tighten the knot by pulling the cords in opposite directions.

Stage 2: Take the right cord over the center cords and behind the left cord, then take the left cord behind the center cords and to the front through the loop. Tighten the knot below the previous knot.

Double Half Hitch = DHH (pic 2): Following the direction of the point, keep the filler cord horizontally in front of the working cords, *take the working cord over the filler cord from the front, then back down, and tighten the knot around the filler cord.* Repeat *-* once more with the same working cord and tighten the knots next to each other.

Diagonal point to the right (pic 3): Using 6 cords, make 2 diagonal DHH sennits to the right on top of each other as follows: Take the 1st cord from the left as the filler cord and first, make 2 DHHs around it, then make 2 DHHs diagonally downwards to the right (keeping the filler cord at a downward right angle) and finally 1 DHH vertically (keeping the filler cord downwards) = 5 DHHs. Then, take the 4 center cords and make 1 SK with them. Again, take the 1st cord from the left as the filler cord and start by making 2 DHHs vertically around it, then 2 DHHs diagonally to the right, and finally 1 DHH = 5 DHHs.

Make a diagonal point to the left as a mirror image as follows: Take the 1st cord from the right as the filler cord and make around it 2 DHHs, 2 DHHs diagonally downwards to the left and 1 DHH vertically = 5 DHHs. Then, take the 4 center cords and make 1 SK with them. Again, take the 1st cord from the right as the filler cord and make around it 2 DHHs, 2 DHHs diagonally to the left, and 1 DHH = 5 DHHs.



Instructions: Cut 54(72)90 working cords of the length 3.8 m / 5 yds from the cord. Hang the lamp shade frame at suitable working height using filler cords and tie the cords to it using Lark's Head Knots as follows: Fold the cord in half in the middle, pass the folded end from the back over the frame to the front, thread the cord ends through the folded loop, and tighten the knot to the frame. Mark the beginning of the round ja move the marker as the work progresses. Start knotting from the left to the right.

Rnd 1: From each side of the beginning of the round, take 2+2 cords and make 1 SK with them (pic 1), *take next 4 cords and make 1 SK with them*, repeat *-* 25(34)43 times more = 27(36)45 SKs.

Rnd 2: Leave 4 cords straight, *take next 4 cords and make 1 SK with them, leave 8 cords straight*, repeat *-* 7(10)13 times more, make 1 SK ja leave the last 4 cords straight.

Pattern Rnd 3: *Take 6 cords and make 1 diagonal point to the right with them (pic 3). Take next 6 cords and make 1 diagonal point to the left with them*, repeat *- 8(11)14 times more.

Rnd 4: From each side of the beginning of the round, take 4+4 cords and make 1 SK with them (= 6 straight cords inside the knot), *leave 1 cord straight, make 1 diagonal DHH to the left (= joining the points), leave 1 cord straight, take next 8 cords and make 1 SK with them*, repeat *- 7(10)13 times more, leave 1 cord straight, make 1 diagonal DHH to the left and leave 1 cord straight.

Pattern Rnd 5: *Take 6 cords and make 1 diagonal point to the left with them. Take next 6 cords and make 1 diagonal point to the right with them*, repeat *- 8(11)14 times more.

Rnd 6: Leave 2 cords straight, *take next 8 cords and make 1 SK with them, leave 1 cord straight, make 1 diagonal DHH to the left (= joining the points), leave 1 cord straight*, repeat *- 8(11)14 times more.

Next, first repeat Rnds 3-6 and then Rnds 3-5 once more = 3 pattern rounds.

Rnd 14: As Rnd 2.

Rnd 15: As Rnd 1.

Then, tie the metal ring to a few spots on the bottom of the knots. Place the working cords inside the ring and make 1 DHH with each of them to the ring. Finish by trimming the fringe ends.

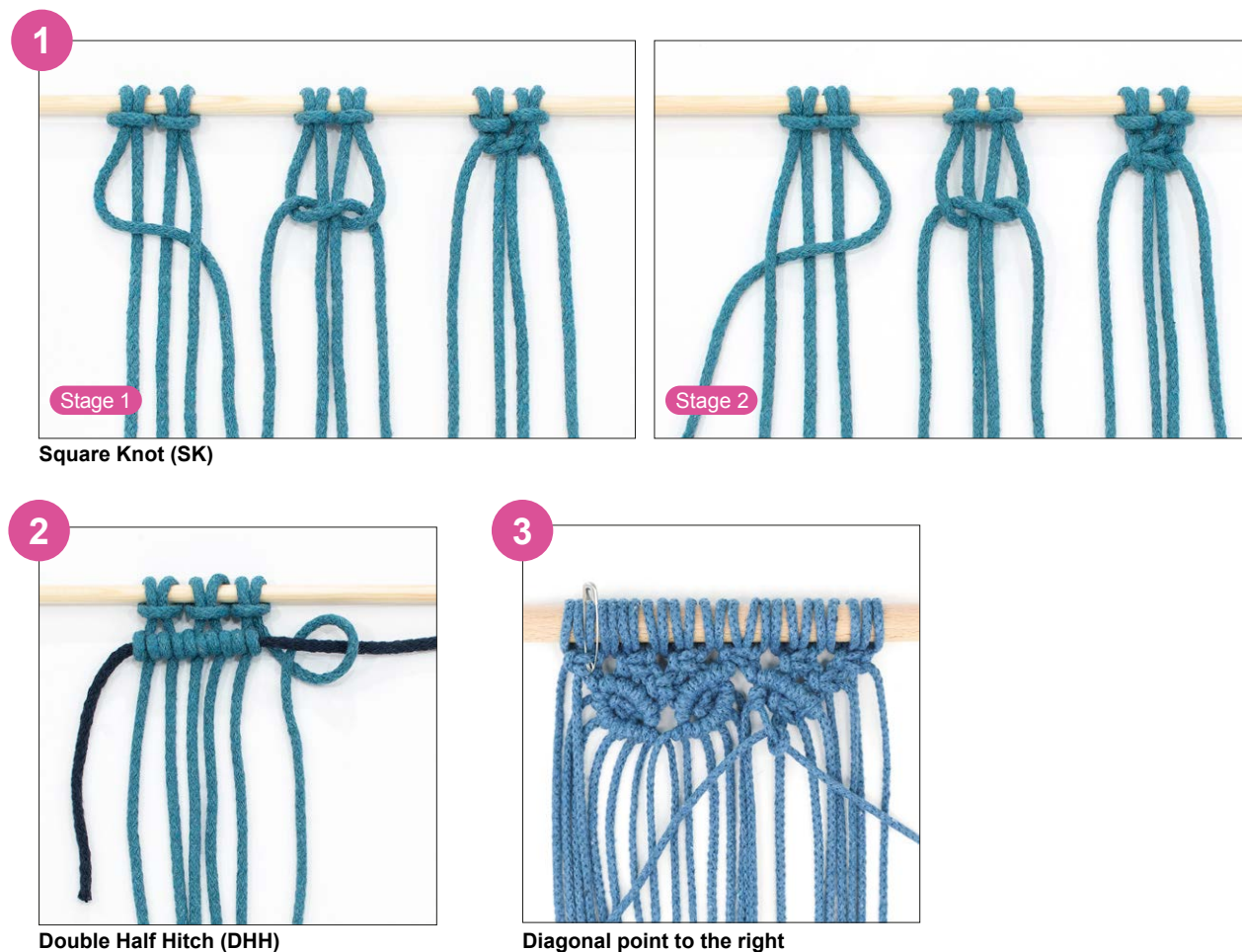

Any commercial use of this pattern is prohibited.